

RANMAN™

LONGRANGERF

UTILITY PROGRAM



Repeaters Coverage graph – Network performance information, including number of units received by each repeater, during a selected time frame

Signal traffic analysis per repeater with an average transmission level, highs and lows



Multiple repeater capacity –up to 256 repeaters

Online display of emergency events



Online display of repeater status

On screen traffic logger



Signal level deviation analysis per repeater



On screen history analysis of network performance of last three days.

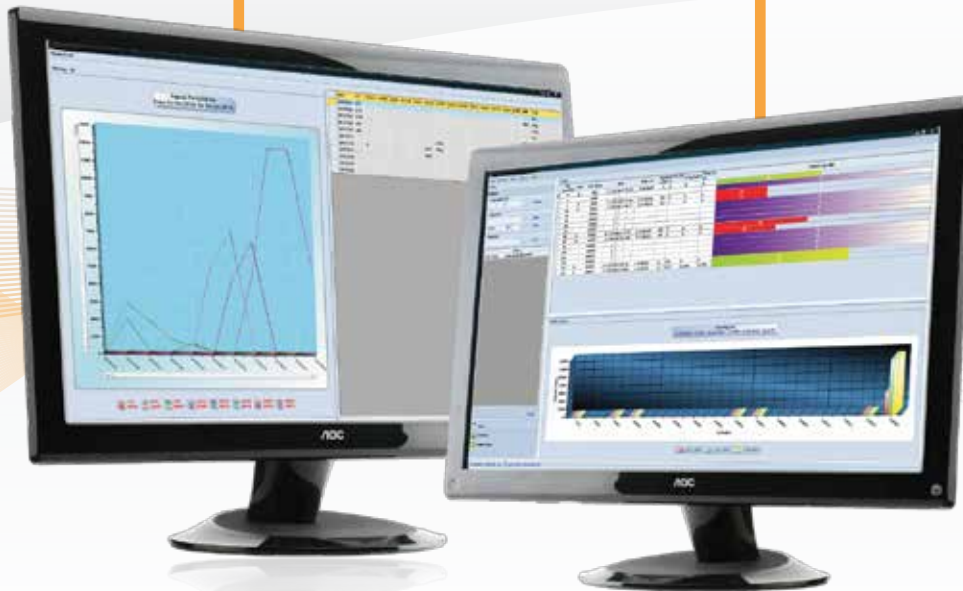

Radio Network Performance Utility

RANMAN™ is a network performance utility that graphically displays the quality of messages received in the central station.

It offers valuable information to management, network administrator, and central station operators alike.

In real time, the program receives messages that contain the transmitter's address, the number of the sub-system, and the signal strength level via the signal-strength measuring module.

Displayed on the main screen, users can obtain on line information that offers an immediate perspective about the overall network status.

In addition, the RANMAN™ offers a variety of statistical and historical reports that are easily extracted, and are crucial for maintaining the network at optimum conditions.

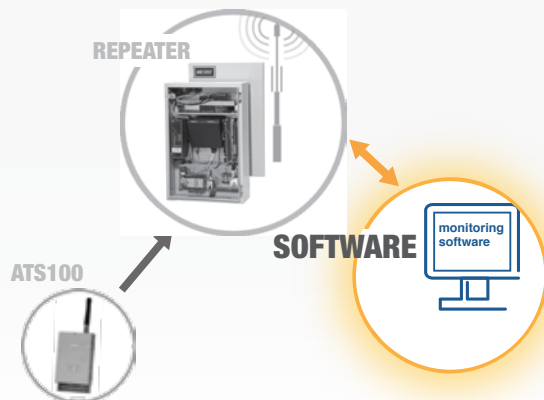

RANMAN™ LONGRANGERF UTILITY PROGRAM



KP
WIRELESSDATA SOLUTIONS

KP Electronic Systems Ltd

PO Box 42, Tefen Industrial Park Tefen, Israel 2495900 | T: +972 4 9873066 /
F: +972 4 9873692 | info@kpsystems.com / www.kpsystems.com